



FLOORSSPACE

For Sublease

565 Great Northern Way

// FULL FLOOR OF NEW OFFICE SPACE

THE LOCATION

Nestled in the False Creek Flats, this AAA property is steps from the future Great Northern Way SkyTrain Station, offering a blend of urban conveniences and natural beauty.

Adjacent to Emily Carr University and the Centre for Digital Media, the neighbourhood is also known as a hub for arts, technology and culture.



THE OPPORTUNITY

565 Great Northern Way

Introducing an opportunity to sublease the entire 3rd floor at 565 Great Northern Way. This exceptional workspace was newly built and delivered in mid-2023.

The flexible layout includes a spacious lounge, well-appointed meeting rooms, and open work areas. The unit features over-height ceilings and large perimeter windows with natural light throughout.

Unit	Third Floor
Area	29,816 SF (approx.)
Term Expiry	August 30, 2030
Availability	30 days' notice
Basic Rent	Please contact listing agent
Additional Rent	\$22.77 PSFPA (2024 est.)

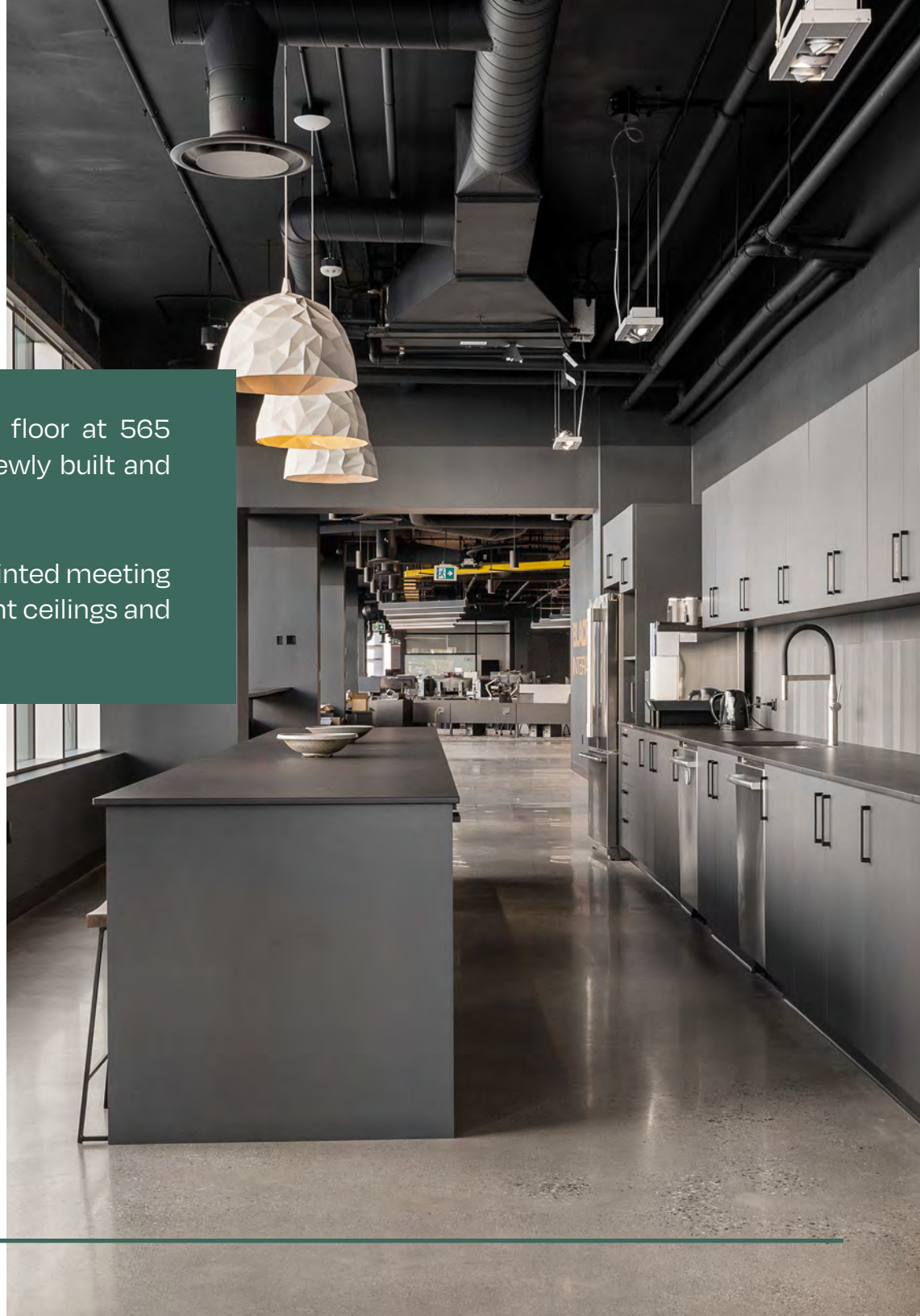



Meeting Rooms

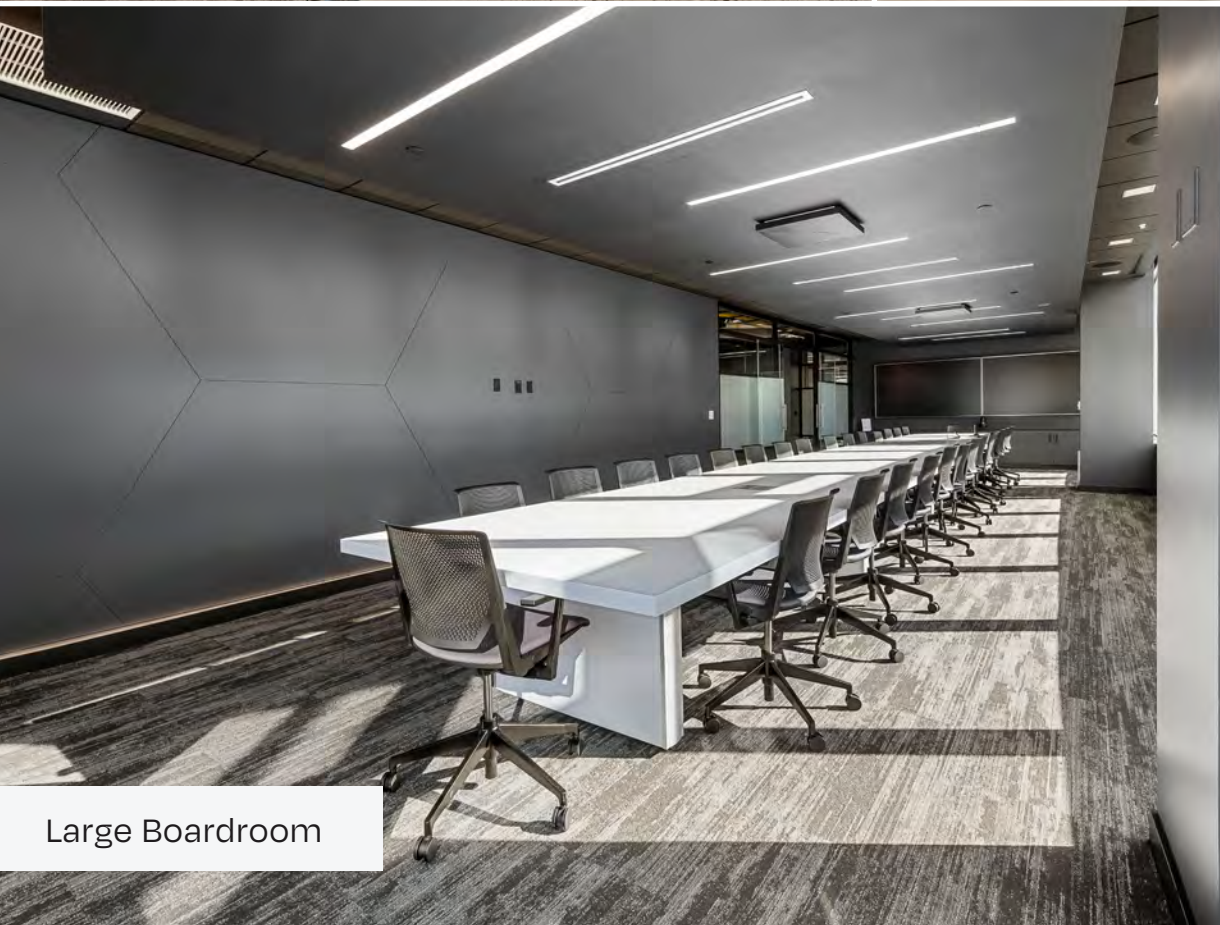

Large Boardroom



Over-height & exposed ceilings

FLOOR PLAN



Full Third Floor | 29,816 SF (approx.)

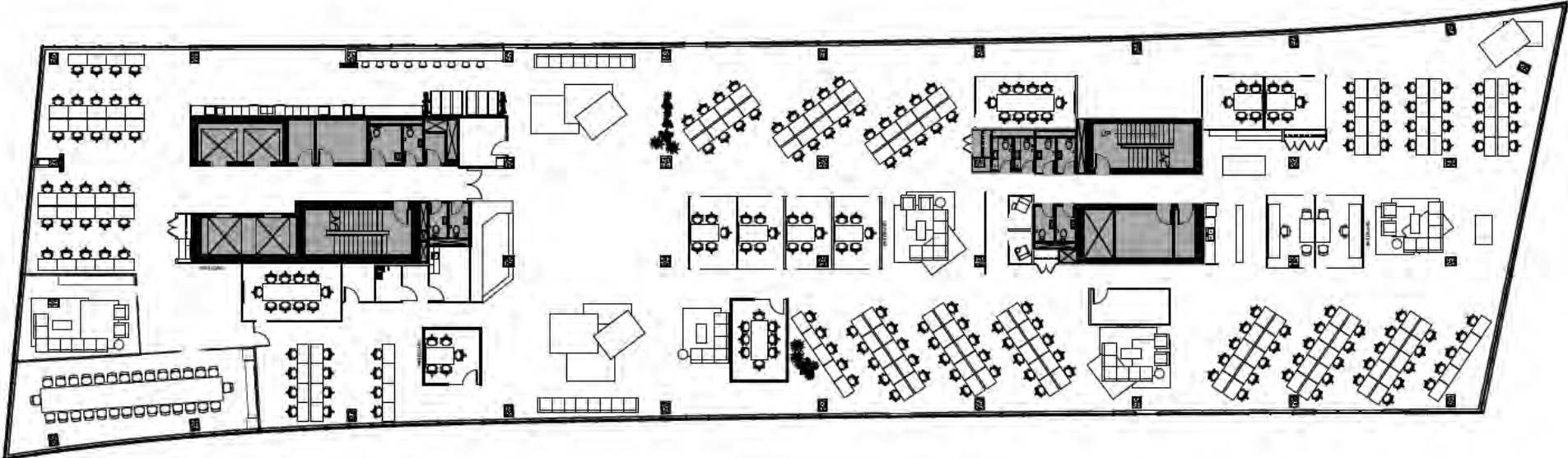

THE BUILDING

Cutting-edge office building with excellent amenities

- Large gym and change rooms
- Shared rooftop patio with panoramic views of the city and North Shore Mountains
- Rooftop meeting room with floor to ceiling windows
- Close proximity to the future Great Northern Way - Emily Carr Canada Line transit station
- Nemesis Coffeehouse located within a public art pavilion resembling a vibrant red flower
- On-site parking
- LEED Gold Certified office building



Nemesis Coffee GNW

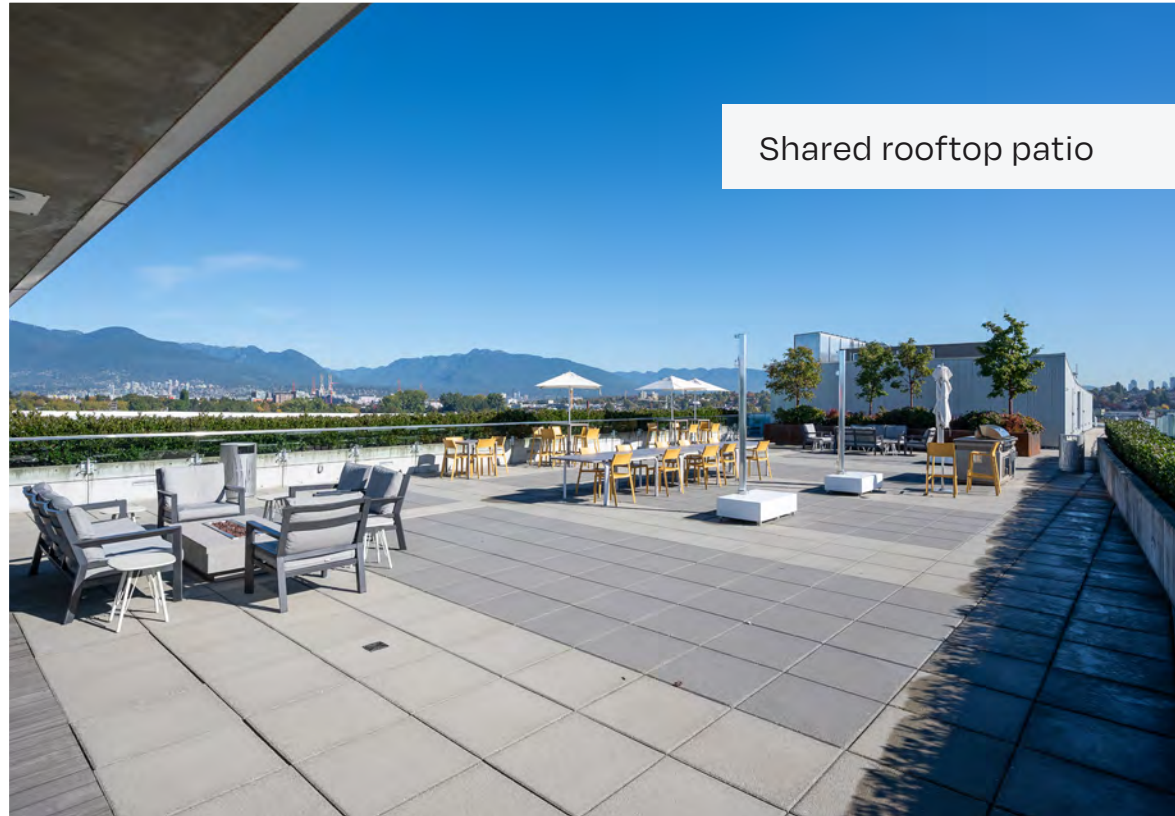

Shared rooftop patio



LOCAL AMENITIES

1. Steve's Poké Bar
2. Nemesis Coffee GNW
3. Beta 5 Chocolates
4. Nuba Cafe
5. Purebread
6. 33 Acres Brewing Company
7. Fable Diner
8. Bar Susu at Novella
9. Red Truck Beer
10. Como Taperia
11. Zarak by Afghan Kitchen
12. Emily Carr University
13. Kafka's Coffee Roasting and Bakery
14. Tim Hortons
15. Cartems Donuts

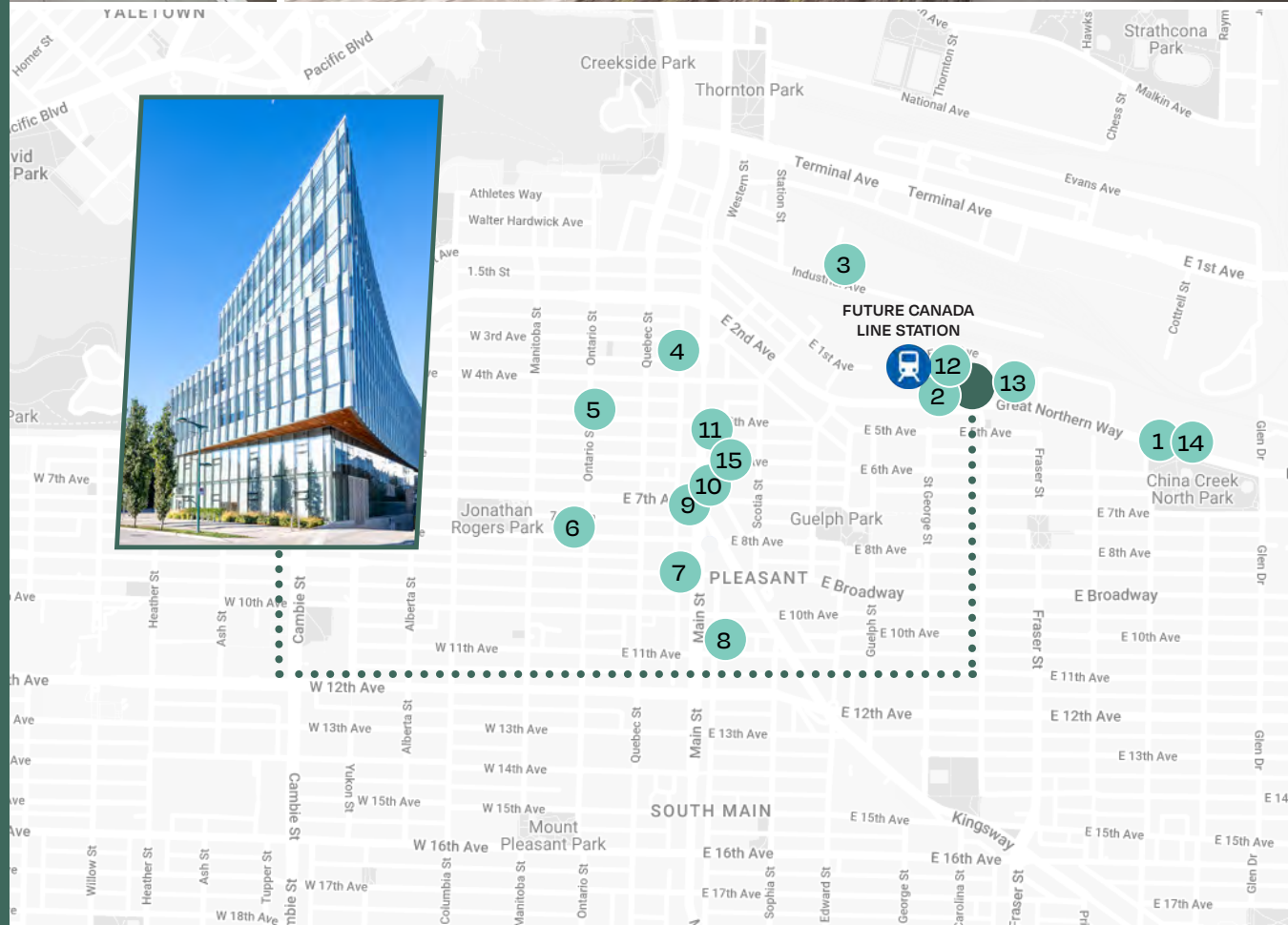



For more information, please contact:



Matt Carlson

Personal Real Estate Corporation

EXECUTIVE MANAGING DIRECTOR

+1 604 328 4603

matt@floorspace.ca

FLOORSPACE

1166 Alberni St., Suite 250

Vancouver, BC Canada

V6E 3Z3

www.floorspace.ca

THIS DOCUMENT HAS BEEN PREPARED BY FLOORSPACE COMMERCIAL INC. FOR ADVERTISING AND GENERAL INFORMATION ONLY. ALL INFORMATION CONTAINED HEREIN IS FROM SOURCES WE DEEM RELIABLE, AND WE HAVE NO REASON TO DOUBT ITS ACCURACY; HOWEVER, NO GUARANTEE OR RESPONSIBILITY IS ASSUMED THEREOF, AND IT SHALL NOT FORM ANY PART OF FUTURE CONTRACTS. PROPERTY INFORMATION IS SUBMITTED SUBJECT TO ERRORS AND OMISSIONS AND ALL INFORMATION SHOULD BE CAREFULLY VERIFIED. ANY INTERESTED PARTY SHOULD UNDERTAKE THEIR OWN INQUIRIES AS TO THE ACCURACY OF THE INFORMATION. ALL MEASUREMENTS QUOTED HEREIN ARE APPROXIMATE. THIS PUBLICATION IS THE COPYRIGHTED PROPERTY OF FLOORSPACE COMMERCIAL INC. AND/OR ITS LICENSOR(S). COPYRIGHT © 2023 FLOORSPACE COMMERCIAL INC.

